



Datenblatt - Fiche technique - Data sheet

**21.17.3066**



ROLINE Junction Box Kat. 6, UTP

ROLINE Module de liaison Cat. 6, UTP

ROLINE Junction Box Cat.6, UTP

1 2 3 4 5 6

A

B

C

D

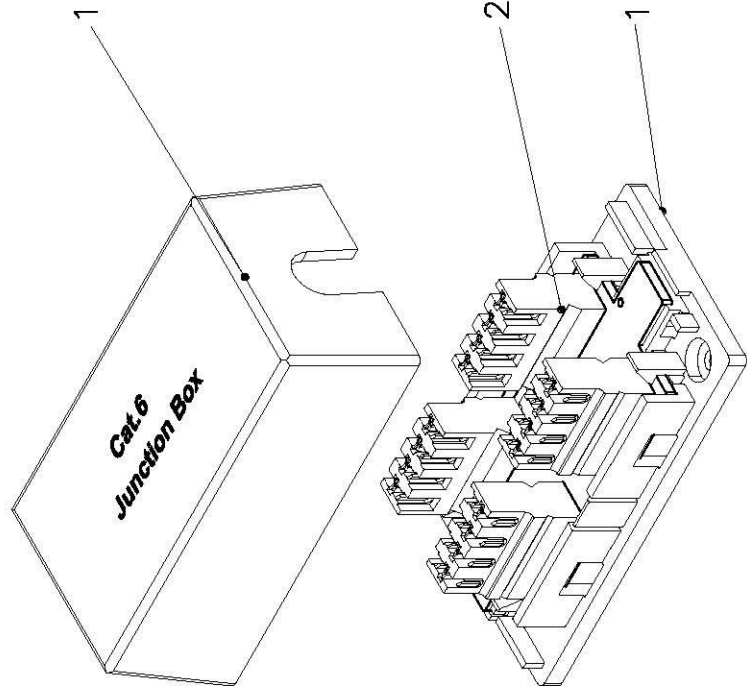
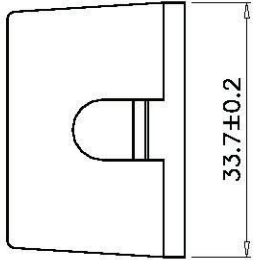
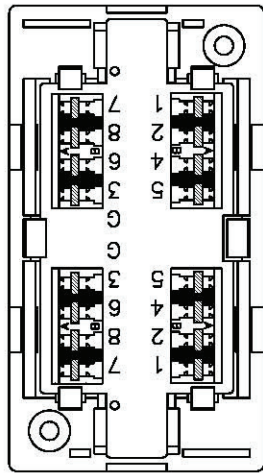
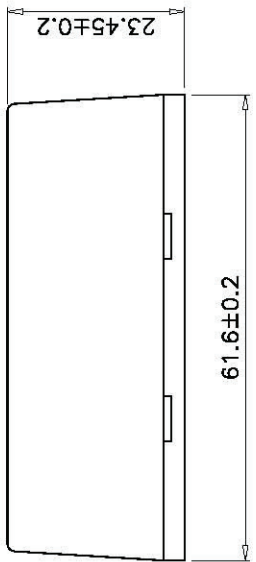
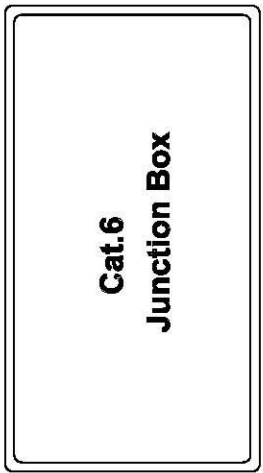

SCALE 1/1

**Specification :**

- Material :**
1. Box : ABS, UL 94V-0, with white color.
  2. IDC :
    - 2-1. Housing : PC+Glass Fiber, UL 94V-2.
    - 2-2. Phosphor Bronze with Tin plated.
  3. PCB : FR4, UL 94V-0.

- Performance :**
- a. T568A & T568B wiring.
  - b. Operating temperature : -10°C to 60°C.(ISO/IEC 11801, ANSI/TIA/EIA 568 B.2)
  - c. Durability :
    - \*IDC : Suitable for 22-26 AWG stranded and solid wire, compatible with both 110 & Krone punch down tools.
  - d. The Cat.6 transmission performance is in compliance with the ANSI/TIA/EIA 568 B.2-1 standard.

NO.	DESCRIPTION	P/N.	MATERIAL	Q'TY
	DRAWING	05.JUN.2013	YAN	
	CHECK	05.JUN.2013	MAER	
	APPROVAL	05.JUN.2013	FRANK	
	SCALE	1/1 (A4)	UNIT	mm
		DATE	NAME	ITEM NO.: 21.17.3066
				ROLINE CAT.6 JUNCTION BOX, UNSHIELDED
				DRAWING NO.
				DRAWING CLASSIFICATION
				SHEET 1 OF 1

No.	MODIFIED AREA	ORIGINAL	MODIFY	DATE	MODIFIER

**rotronic**

DRAWING NO. 10cm

DRAWING CLASSIFICATION S SHEET 1 OF 1